



# BUILD THE FUTURE



# IT'S TIME TO BUILD



Since the beginning of Journey we have been about taking steps—meeting people where they are and helping them take their next steps to follow Jesus.

Once again it's time for us to take a major step together as a church. We are making room for more friends and more family.

It's a **BIG** leap but there is no such thing as faith without **RISK**. I'm asking you to pray like you've

never prayed before, to show up at church, to attend **BUILD the Future** events, and to step out boldly in faith and giving.

Let's **BUILD the Future** together, and take the good news of Jesus forward. One step at a time. The best is yet to come!



Scotty Priest // Lead Pastor

And they said, “Let us rise up and build.” So they strengthened their hands for the good work.

## TABLE OF CONTENTS

- Our Story **04 •**
- Expanding Impact **05 •**
- Journey Stats **06 •**
- Our Next Steps **07 •**
- Our Goals **08 •**
- Q&As **14 •**
- What Can You Do? **15 •**





# OUR STORY 04

Our story began as a small group of believers meeting in a hotel ballroom. In 2007, we moved into an old grocery store off Holly Street and built something special, a place where people met Jesus and lives were transformed.

That group of people became Journey Church.

In 2015, we purchased 12 acres off I-25 for \$450,000. Through our first BUILD campaign, that land was paid for in cash. By 2017, we had moved into our first permanent home in Castle Pines.

What started as a small community of 500 quickly exploded in growth. By Christmas 2019, over 4,000 people packed into that little building. Then came 2020. Despite the challenges, God remained faithful. Journey resumed growing in 2021. And by 2023, it was time to build again.

And you showed up.

Through your bold generosity, we expanded Castle Pines, launched a dynamic Residency Program, and opened new locations in Parker and Lone Tree.

The result? Explosive growth in the number of people finding their hope in Jesus, hundreds of baptisms, and a movement in our Next Gen ministry that's changing everything.



Since expanding the Castle Pines building and launching both the Parker and Lone Tree locations, the growth of Journey has been exponential. When we moved to our original building in 2017 we were a church of about 500 attenders, today, around 3,000 people gather weekly at our three locations.

It's not just about the thousands of people who call our church home. It's about the stories we hear every week of lives changed, marriages being restored, and people taking their next steps with God. And it's because all along the way, every time we've asked, faithful people have taken big steps of generosity.

And now it's our turn to do it again.

# EXPANDING IMPACT

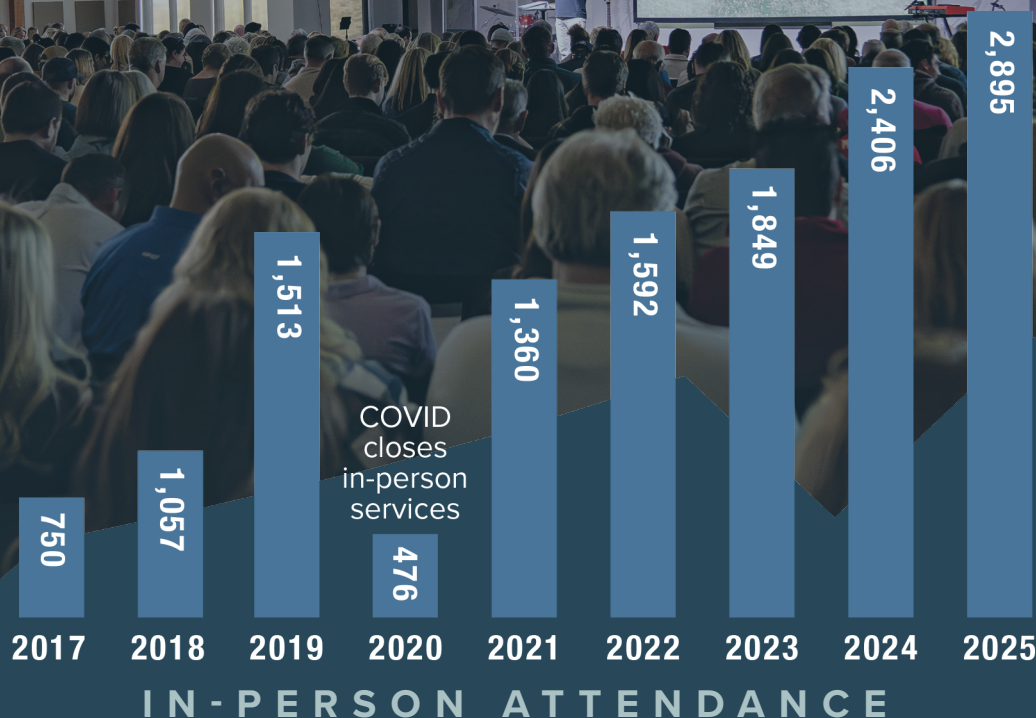

# JOURNEY STATS

SINCE OUR LAST BUILD PROJECT



**4,000**

FIRST-TIME  
GUESTS  
ATTENDED  
JOURNEY



**2,500**

FIRST STEP  
BOXES  
GIVEN AWAY



**366  
MORE**

NEW KIDS  
ATTENDING



**400  
MORE**

NEW MIDDLE  
SCHOOL  
AND HIGH  
SCHOOL  
STUDENTS  
ATTENDING



**800  
MORE**

NEW  
ADULTS  
IN SMALL  
GROUPS



**\$1M+**

GIVEN TO  
COMMUNITY  
IMPACT AND  
MISSIONS



## BUILD

is a 2-year giving initiative  
to help make room for:

More Families

More Friends

More Kids

More Students

More Baptisms

More Ministries

More Space

More Lives Changed

# OUR NEXT STEPS

Before we look at what we're building, let's talk about why.

## BECAUSE OF PEOPLE.

**THOUSANDS** are moving into our community—many far from God. They need a spiritual home.

The **NEXT GENERATION** is facing anxiety, depression, and loneliness like never before. We must raise up leaders to guide them with truth and hope.

Around the **WORLD**, people desperately need what we so often take for granted—resources, hope, and the Gospel.

This is more than a building campaign.  
This is a calling to make an **ETERNAL IMPACT**.



THE GOAL IS **\$10 MILLION** OVER 2 YEARS  
TO DO WHAT?

## \$8 MILLION FOR THE PARKER BUILDING

Establish a permanent home for our Parker location—a space that will serve the community for generations to come. The new building will include a 350-seat auditorium, dedicated kids and student environments, and space for ministry seven days a week.



Space to grow to  
1000 people



Prime location in  
growing Parker  
community



24/7 ministry  
space

## \$1 MILLION FOR THE NEXT GENERATION



Student ministry  
at all Journey  
locations



More Residents in  
kids and student  
ministries



Resources for  
parents and  
families



Student ministry  
campus outreach



Planting churches  
across **Europe**



Building a  
Compassion  
Center in **Peru**



Constructing a new  
church building in  
**Haiti** with Hope  
Rising Haiti



Adding a chapel  
in **Uganda** with  
Musana



More **local**  
outreach at all  
locations

## \$1 MILLION FOR MISSIONS



**\$8 MILLION** FOR OUR PARKER LOCATION



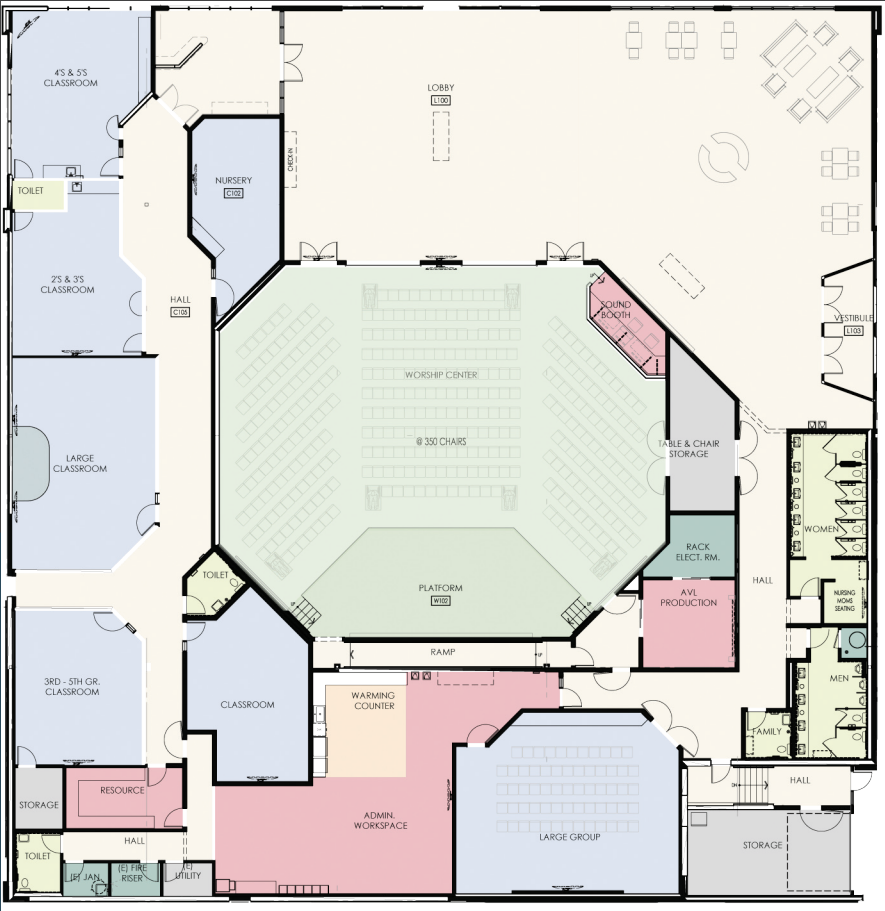

FLOOR PLAN



\$1 MILLION FOR NEXT GEN





\$1 MILLION TO MAKE A GLOBAL IMPACT



# QUESTIONS & ANSWERS

14

## **What are the best ways to give financially to BUILD the Future?**

We encourage everyone who calls Journey Church home to pray and ask God what you should give, and then do what God says. For many, this will be through generosity above their normal, regular giving.

## **Are we allowed to have a church in Parker at the La-Z-Boy building location?**

YES! We have the approval from the Town of Parker zoning department for occupancy and use as a church facility.

## **Is there enough parking, and where will we park?**

YES! We have 123 off-street spaces shared with neighboring lots—exceeding the 117 required for our 350-seat capacity. Additional on-street parking is also available. A traffic study, approved by the Town of Parker, confirmed adequate traffic flow, and our Parking Team will ensure a safe and smooth experience on Sundays.

## **How long will construction take?**

We anticipate the total remodel project to take 4–6 months. We are working with the same construction team that assisted us with our Castle Pines expansion.

## **Are we going to take on any debt for these projects?**

The goal is that we add no additional debt for the church. This keeps money available for ministry, rather than debt service.

## **When will we begin holding in-person services at the NEW Parker Location?**

Because of the generosity of our people, we are expecting we can begin holding in-person services in early 2026.

## **Is it better to give our financial gift as a one-time gift or on a recurring basis?**

To make such a generational impact, it will take both for most of us. For some, this will be through one-time gifts from stored assets (cash, stocks, 401k, real estate, bitcoin, etc.), and through ongoing monthly contributions.

## **How long is my financial commitment?**

We are asking everyone who calls Journey Church home to make a two-year commitment above and beyond their regular giving.

## **How will we reach more families with the \$1M investment?**

We're investing \$1 million to change the story for the next generation—providing the resources, staff, and leaders needed to reach, build, and equip 10 times more kids, students, and parents.

## **What will we do with the \$1M of funds raised for missions?**

We're committing \$1 million to make a global impact—supporting Journey Christmas Stores; launching church plants in Denver and beyond; and helping build a church in Haiti, a chapel in Uganda, and a Compassion Center in Peru that will serve families for years to come.

## **Does Everyone get a La-Z-Boy?**

Great question, but...No. However, we will have very comfortable seating in the auditorium and beautiful furniture in the atrium to hang out in.

# WHAT CAN YOU DO?



## PRAY

Ask, "God, what's our part in building the future?"



## PREPARE

Be open to bold, faith-filled obedience.



## PARTICIPATE

Step out in faith. Give above and beyond over the next two years to help **BUILD the Future.**

*Commitment Sunday, October 19, 2025*



JourneyColorado.com/**Build**

## 2-YEAR GIFT CHART

GIFTS NEEDED	TWO-YEAR GIFT LEVEL	ANNUAL GIFT	MONTHLY GIFT
1	\$1,500,000	\$750,000	\$62,500
1	\$1,000,000	\$500,000	\$41,666
1	\$750,000	\$375,000	\$31,250
1	\$500,000	\$250,000	\$20,833
2	\$250,000	\$125,000	\$10,416
8	\$100,000	\$50,000	\$4,166
12	\$75,000	\$37,500	\$3,125
15	\$50,000	\$25,000	\$2,083
25	\$35,000	\$17,500	\$1,458
20	\$25,000	\$12,500	\$1,041
20	\$20,000	\$10,000	\$833
30	\$15,000	\$7,500	\$625
40	\$10,000	\$5,000	\$416
75	\$5,000	\$2,500	\$208
Many	\$2,500	\$1,250	\$104

• **TOTAL \$10,000,000** •

# TAKE YOUR NEXT STEP



Mailing Address  
9009 Clydesdale Road  
Castle Rock, CO 80108

720.532.1049

[Info@JourneyColorado.com](mailto:Info@JourneyColorado.com)

[JourneyColorado.com](https://www.JourneyColorado.com)